



ADKINS ARBORETUM

PROGRAMS & EVENTS

WINTER 2011



ADULT PROGRAMS

Pre-registration is required for all programs. Register online at www.adkinsarboretum.org, call 410-634-2847, extension 0, or e-mail info@adkinsarboretum.org.

Gap Ecology

THURSDAY, APRIL 7, 10–11:30 A.M.

FEE: \$15 MEMBERS, \$20 GENERAL PUBLIC

What happens when a tree falls in the forest? A gap forms! Gaps are extremely important to the development of forests. Join plant ecologist Sylvan Kaufman to learn about the science behind gaps and to investigate a two-year-old gap at the Arboretum. Learn how trees at the edges respond, what new plants are likely to grow, and what animals use gaps. Use your new knowledge to better understand the natural history of the forest and forest management. This class will be indoors and outdoors, weather permitting.

Designing the Native Forest

FRIDAYS, APRIL 22 AND 29, 10 A.M.–2:30 P.M.

FEE: \$85 MEMBERS, \$110 GENERAL PUBLIC

Planting a native forest is one of the most powerful things we can do to support biodiversity and bring nature to our home landscapes. Even a thin strip of forest along the edge of an open area can provide shade and enjoyment for people, important watershed benefits for the Bay, and precious food and shelter for wildlife. Although a full-blown, completely natural forest might be difficult to accommodate in many neighborhoods and other public settings, this program series provides detailed instruction on a popular new concept: a stylized, low-maintenance native forest.

Participants in this class will learn how to design a native-plant forest using techniques to reduce maintenance and enhance the “acceptability” of the forest for a neighborhood setting. Topics will include the four distinct layers that make up the forest with specific native plants that can be used at each layer, as well as the wildlife value of the plants. Special attention

will be paid to matching plants to site conditions. There will be some reading and homework requirements. Participants are encouraged to bring their own specific project to work on throughout the duration of the class.

Christina Pax, a landscape design professional, holds a graduate degree in sustainable landscape design. She uses her keen interest in native plants to make gardens a year-round attraction for people and wildlife.

Ecology of the Forest in Spring

THURSDAY, APRIL 28, 1–3 P.M.

FEE: \$15 MEMBERS, \$20 GENERAL PUBLIC

Spend a spring afternoon outdoors with plant ecologist Sylvan Kaufman. This program will look closely at the plants, fungi, insects, and bird life in upland and floodplain forests at the Arboretum and compare and contrast the habitats and communities. If you took *Layers of the Forest* in the fall, this class will look at the same locations in spring. Whether you are interested in natural history, botany, or just being outdoors, this class will appeal. Binoculars and a hand lens are recommended.

(Adult Programs continued on page 2)





LANDSCAPE DESIGN SERIES

Find inspiration for spring gardening in this four-part series that focuses on garden and landscape design. Discover the world's most creatively designed gardens in *A Garden Odyssey*, and learn practical principles of sustainable design with *Energy-Wise Landscape Design* and *Landscape Audits*. A popular all-day *Landscape Design Workshop* will teach participants to tackle landscaping issues particular to the Eastern Shore, while *Designing Extraordinary Mixed Plantings* will reveal the artistry of combining plants for year-round beauty.

A Garden Odyssey – In Search of the World's Most Creative Gardens

FRIDAY, FEBRUARY 25, 1–2 P.M.

FEE: \$15 MEMBERS, \$20 GENERAL PUBLIC

Imagine traveling the world in a passionate search for the most creatively designed gardens. In 2002, under the auspice of the Chanticleer Fellowship, Scott Scarfone was given the opportunity to expand his knowledge of society and culture as expressed through these gardens' physical representations and intrinsic meanings.

His travels have led him to England, to garden at Great Dixter with the late Christopher Lloyd; to Italy, to visit the gardens of the Renaissance; to Japan, to view the ancient gardens of Kyoto and Nara; to Thailand, to study Eastern philosophy and garden design; to Costa Rica, to see tropical vegetation in a native rainforest environment; and to California, to study Mediterranean plants in a design style that only California can boast. This lecture highlights Scarfone's excursions across the globe and illustrates some of the most prolific gardens ever created.

Visit Chanticleer Garden, one of the gardens featured in Scott's lecture, on Friday, April 1. See page 6 for details.

Energy-Wise Landscape Design

FRIDAY, MARCH 4, 1–2:30 P.M.

FEE: \$15 MEMBERS, \$20 GENERAL PUBLIC

Residential consumption represents nearly a quarter of North America's total energy use, with the average homeowner spending thousands of dollars a year on power. Join landscape architect Sue Reed as she demonstrates—in her own design projects and many others across New England—the principles of designing landscapes to save on home heating and cooling costs. This talk also shows how to minimize fuel used in landscape construction, maintenance, and everyday living, and how to choose materials with lower embedded energy costs.

Reed is a registered landscape architect who has helped hundreds of homeowners create comfortable, livable, and beautiful energy-saving landscapes. She has worked in western Massachusetts for nearly 25 years, including twelve years as an instructor at the Conway School of Landscape Design. Her recent article, "Sustainable Landscape Design," appears in Volume II of the new *Encyclopedia of Sustainability*. Her new book, *Energy-Wise Landscape Design*, will be available for purchase.



Landscape Audits: Evaluating the Sustainability of Your Landscape

WEDNESDAY, MARCH 16, 1–2:30 P.M.

FEE: \$15 MEMBERS, \$20 GENERAL PUBLIC



Your home landscape should be more than just a pretty face. It should also be a healthy ecosystem, supporting biodiversity, infiltrating water, storing carbon, cooling the air, and supplying all the functions known as ecosystem services. In this presentation, look at your landscape through a “green” lens, learn the basics

of landscape audits, and find out how to analyze your landscape to improve sustainability and enjoy functionality as well as beauty.

Toni Bailey works to improve both the beauty and the sustainability of suburban Maryland landscapes, and believes that enlightened management improves the quality of life for all. She earned a Master of Landscape Design from George Washington University with a concentration in sustainability. She is the house landscape expert at Amicus Green Building Center in Kensington, MD, and is principal of Gracefully Green, LLC in Rockville, MD, specializing in landscape sustainability consulting and design.

Landscape Design Workshop

SATURDAY, MARCH 26, 8:30 A.M.–4:30 P.M.

FEE: \$85 MEMBERS, \$110 GENERAL PUBLIC

This workshop will address the typical landscaping challenges of Eastern Shore homeowners. Four experienced landscape designers and avid gardeners will lead participants through an all-day intensive design session. Come with your challenges and dreams, and leave with a landscape plan, ideas, and confidence to transform your home landscape. Topics include analyzing the challenges and opportunities of your property; developing a plan for circulation and unique features; designing “rooms” for outdoor living; choosing materials for patios and walks; incorporating sustainable practices; and selecting ornamental plants. The day will be organized around presentations followed by breakout sessions for participants to work one-on-one with designers. The designers will offer practical advice on how to get started; what to do with wet areas; how to lay out a path; how to screen an undesirable view; and plants recommended for specific conditions. Step by step, participants will develop their own landscape designs.

REGISTER ONLINE FOR PROGRAMS—IT'S EASY!
VISIT WWW.ADKINSARBORETUM.ORG.

Workshop leaders are Arboretum Executive Director Ellie Altman; Washington, DC, landscape designer Ed Colahan; landscape architect Barbara McClinton, formerly of the Baltimore landscape architecture and land planning firm Daft, McCune, Walker; and landscape designer and native plant enthusiast Chris Pax, a graduate of the George Washington University sustainable landscape design master's program.

Bring lunch. A continental breakfast and break refreshments will be provided. Also bring a property plat, photos, and other documentation of your property. Worksheets and handouts on native plants will be provided. Limited to 16 participants.

Designing Extraordinary Mixed Plantings

SATURDAY, APRIL 16, 1–2 P.M.

FEE: \$15 MEMBERS, \$20 GENERAL PUBLIC

Uncover the aesthetic charm of well-designed mixed beds and the foundations of design upon which they were built. This program is a synopsis of Scott Scarfone's award-winning book *Professional Planting Design—An Architectural and Horticultural Approach for Creating Mixed Bed Plantings*, which earned a Merit Award from the Maryland and Potomac Chapters of the American Society of Landscape Architects in 2007. The most memorable planting beds are those that provide contrast, variety, textural differences, and color throughout the year. Their visual interest rests in their ability to continually change, season after season. Planting designs that best create this effect are those that intersperse combinations of shrubs with perennials, grasses, bulbs, and groundcovers. Mixed beds must be carefully orchestrated to avoid visual dysfunction and create visual harmony. A true mixed bed exemplifies teamwork. Each plant provides support to its neighbor, covering weaknesses and supporting strengths. Scott's book will be available for purchase.



(Adult Programs continued on page 4)



Sumi-e Painting

SUNDAY FEBRUARY 6, 1-3 P.M.

SUNDAY, MARCH 6, 1-3 P.M.

FEE: \$30 MEMBERS, \$35 GENERAL PUBLIC (EACH SESSION)

Learn how to meditate and relax while painting the “chi” of nature, as Buddhist monks called the Chan did a thousand years ago. Instructor Dawn Malosh will teach the traditional meditative Eastern approach and style to nature and nature painting. Participants will learn about traditional Eastern painting media, such as the bamboo brush, sumi-e ink, rice paper, and suzuri inkwell. There will be plentiful opportunities to connect to the spirit of nature while creating beautiful monochromatic nature scenes and landscapes inspired by the Arboretum’s natural beauty. This is a simple approach to painting, and all artistic levels are welcome. All materials will be provided.

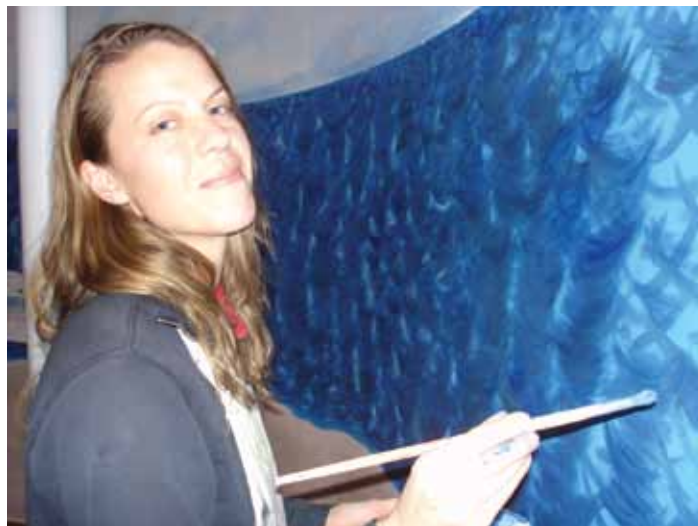

Dawn Malosh

Nature-Inspired Texture Painting

MONDAYS, FEBRUARY 21 AND 28, 12:30-3:30 P.M.

FEE: \$60 MEMBERS, \$80 GENERAL PUBLIC

Get up-close and personal with nature in this investigation of texture and non-objective painting techniques. Participants will learn techniques to see, feel, and intensify the wondrous textures of the natural world while exploring the enjoyable process of creating abstract texture paintings. All materials will be provided.

Surrealistic Landscapes

SUNDAYS, MARCH 13 AND 27, 12:30-3:30 P.M.

FEE: \$60 MEMBERS, \$80 GENERAL PUBLIC

Learn about the unique and fascinating landscapes of surrealist artists Salvador Dali, Rene Magritte, and Remedios Varo while composing your own unique landscape painting. Teaching artist Dawn Malosh will guide participants through the process of composing a surrealist landscape that symbolically expresses a landscape of their dreams as well as their own hearts and minds. All materials will be provided.

Botanical Art: A Continuing Tradition

TUESDAY, FEBRUARY 22, 1-2 P.M.

FEE: FREE WITH ADMISSION

Botanical Illustrator Fran Phaneuf will introduce botanical art and its rich history in this slide presentation. Learn about the value of early botanical illustrations to herbalists and physicians as well as their role during the Age of Discovery to disseminate knowledge about the new plants brought to Europe by early explorers. The tradition of botanical art continues today in the paintings of many fine contemporary artists whose works are featured in the lecture.

Phaneuf is a member of the American Society of Botanical Artists and has studied botanical painting in Great Britain with Anne Marie Evans and at Longwood Gardens with Joan Frain. Her paintings have been exhibited at the Philadelphia Flower Show, Chantecleer, Morris Arboretum, and other venues in the Philadelphia area.

Illuminated Garden Journals

SUNDAYS, APRIL 3 & 10, 1-3:30 P.M.

FEE: \$60 MEMBERS, \$80 GENERAL PUBLIC

Create your own illuminated garden journal using illuminated manuscript techniques from medieval times. Join instructor Dawn Malosh to explore patterning, decorative designs, interlacing, simple book-binding, and gold leaf in this two-week workshop. All materials will be provided.

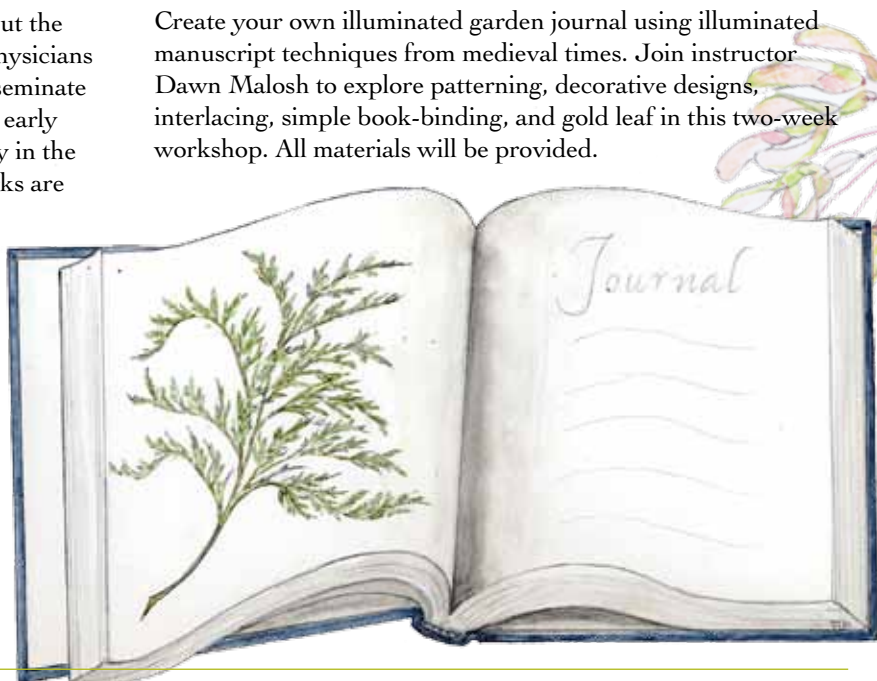



Nature as Muse—Walk and Reflection with Nature Journaling

SATURDAYS, FEBRUARY 5, MARCH 5, APRIL 2, 11 A.M. PUBLIC GUIDED WALK FOLLOWED BY JOURNALING SESSION
FREE WITH ADMISSION

Join one of the Arboretum’s docent naturalists for a walk through the forest. Listen to the muse of the trees, breathe in the forest air, and walk along paths dappled with sun and shadow. Enjoy the theme of the day and return to the Visitor’s Center to write/journal about your flights of fancy inspired by the wood nymphs, or just research the plants that intrigued you in the reference library. No previous writing experience is required; bring your favorite journal if you have one. Reservations requested.



Exploring Nature and Five Movements of Life Through Writing, Reflection, and Community

WEDNESDAYS, JANUARY 19 AND APRIL 6, 1–4 P.M.
FEE: \$25 MEMBERS, \$30 GENERAL PUBLIC (EACH SESSION)

Many cultures look to nature as teacher, and we too might use nature’s lessons to encourage our own growth and connectedness to life around us. By exploring five elements honored in traditional Chinese wisdom, we can be a part of the graceful flow of seasons. The January session will reflect on winter, where we might go into our own well of wisdom and practice deep listening and stillness. The April session will focus on an upward cycle of new growth, clarity, and possibility in our own lives.

We will explore these cycles through poetry, gentle writing exercises, and simple art activities. No previous experience in these areas is necessary! The Arboretum provides a perfect location to immerse oneself in the cycles of nature and discover how these cycles speak to our own lives.

Instructor Katherine Johnson is a life coach and teacher of creative practices as SoulCollage®, writing, meditation, and personal growth. She holds a doctorate from the University of Maryland and teaches for Tai Sophia Institute and Johns Hopkins University, as well as several holistic learning centers. Katherine’s life journey has integrated practices of traditional professional development with a rich blend of holistic learning. She brings joy and love as she serves.

(Adult Programs continued on page 6)

**REGISTER ONLINE FOR PROGRAMS—IT’S EASY!
VISIT WWW.ADKINSARBORETUM.ORG.**



Acer rubrum
red maple



of gardens. Sculptural, homemade seats, benches, wrought iron fences, and bridges highlight the uniqueness and personal nature of the garden.

In addition to the horticultural expertise of the Chanticleer staff, many employees have other talents that contribute to the uniqueness of the garden. Their talents range from wood working, stone carving, painting, metal working, to the union of bamboo canes and rebar to provide creative supports. Take a look at some of their artistry as you stroll through the garden.

For more information about Chanticleer Garden, visit www.chanticleergarden.org.

Chanticleer Garden

FRIDAY, APRIL 1, 8 A.M.–5 P.M.

FEE: \$65 MEMBERS, \$80 GENERAL PUBLIC

Fee includes bus transportation, admission, house and garden guided tour, and lunch. Group is limited to small bus size of 25. Please register early to ensure seating.

Truly one of the world's most creative gardens, Chanticleer is located just outside Philadelphia in Wayne, Pennsylvania. Originally the estate was known for its majestic trees and verdant lawns. Today the trees and lawns remain, but the focus is on plant combinations, containers, textures, and colors, often relying on foliage more than flowers.

Tens of thousands of bulbs clothe the ground in spring, followed by orchards of flowering trees with native wildflowers blooming in the woods. A vegetable garden complements a cut-flower garden. Courtyards are a framework for unusual combinations of hardy and tropical plants. Vines grow in nooks and crannies, trailing and twining. A serpentine of cedars, boulders, and agronomic crops undulates through a mown hillside.

A woodland garden full of rarities leads to a water garden surrounded by exuberant perennials. A ruin plays with indoor/outdoor relationships and contrasts the light and dark sides

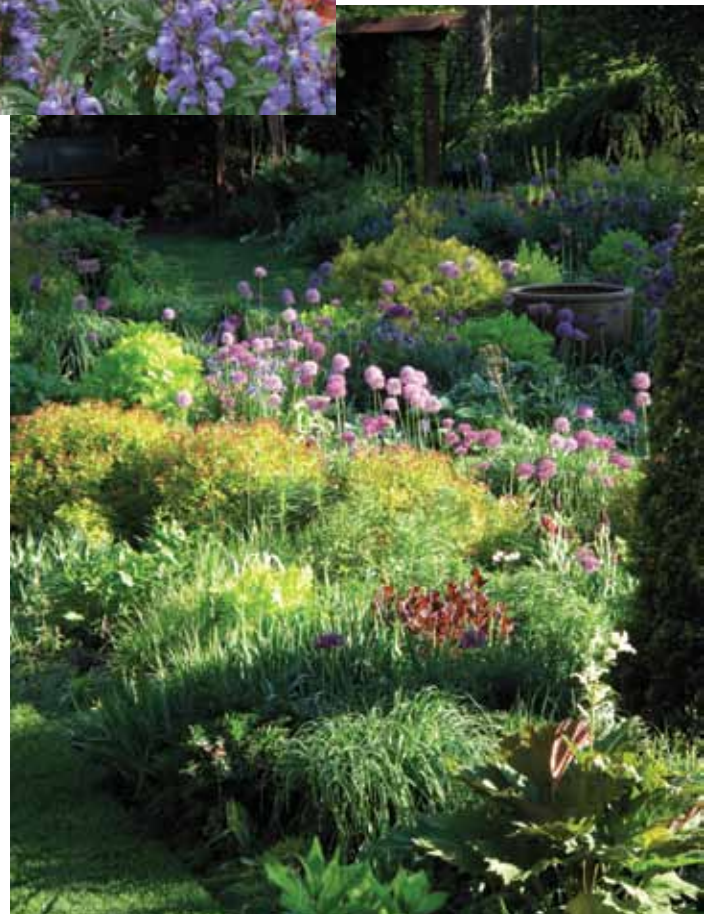

Bowman's Hill Wildflower Preserve

WEDNESDAY, APRIL 20, 8 A.M.–6 P.M.

FEE: \$75 MEMBERS, \$90 GENERAL PUBLIC

Fee includes bus transportation, admission, guided tour of preserve, and lunch.

Group is limited to small bus size of 25. Please register early to ensure seating.

Bowman's Hill Wildflower Preserve (BHWP) in New Hope, PA, is home to nearly 800 native plants of PA, including more than 80 rare and endangered species. Join a guided walk of the Preserve trails that wind through woodlands, meadows, and along a pond and Pidcock Creek, where you'll enjoy an abundance of seasonal wildflowers and other native plants, birds, and wildlife.

The Preserve focuses exclusively on native plants, in distinction from botanical gardens that may include natives in their collections. BHWP cares for and protects their native plant collection with the goal of encouraging the public to visit, enjoy, and learn about the richness of Pennsylvania's natural heritage, so they, in turn, also become stewards of the natural world.

After visiting BHWP for the day participants will have the opportunity to visit nearby New Hope and/or Lambertville, NJ (located across the Delaware River from each other), and pick up a coffee or snack for the bus ride home.

For more information about Bowman's Hill Wildflower Preserve please visit their website at www.bhwp.org.

Nature's Role in the Underground Railroad

SUNDAY, MARCH 20, 1–3 P.M.

SATURDAY, APRIL 9, 1–3 P.M.

SATURDAY, APRIL 30, 7–9 P.M.

FEE: \$5 MEMBERS, \$10 GENERAL PUBLIC

Anthony Cohen returns to the Arboretum to lead a series of guided walks to explore the cross-section in history and culture that combines the story of the Underground Railroad and the natural landscape of the Eastern Shore.

With its forests, thickets, marshes, rivers, and creeks, the Eastern Shore's natural landscape provided an opportunity for hundreds, and possibly thousands, of slaves to attain freedom, including Frederick Douglass and Harriet Tubman. Designated as a "Place to Visit" on the Harriet Tubman Underground Railroad Byway, the Arboretum reflects the conditions slaves had to travel through en route to freedom, and serves as a dramatic vista to experience the little-known relationship between nature and the Underground Railroad.

The guided walk will be followed by an informal conversation to discuss ongoing opportunities to interpret nature's role in the Underground Railroad. Light refreshments will be served

Cohen is a historian, author, and explorer of the American past. He has twice walked routes of the Underground Railroad and

will chronicle his third journey as a documentary film titled *Patrick & Me*, to be released in 2011. Cohen has served as consultant to the National Parks Conservation Association, Maryland Public Television, and NASA and trained Oprah Winfrey for her role as Sethe in the film *Beloved*. He is founder and executive director of **The Menare Foundation, Inc.**, a nonprofit preserving the legacy of the Underground Railroad.

This program is partially funded by a grant from Eastern Shore Heritage Inc. (ESHI), the managing entity of The Stories of the Chesapeake Heritage Area.

Founding Gardeners – Lunch and Lecture

MONDAY, APRIL 25,

NOON–1 P.M. LUNCH,

1–2:30 P.M. LECTURE

FEE: \$35 MEMBERS,

\$40 GENERAL PUBLIC

"Founding Gardeners" offers a fascinating look at the Revolutionary generation from the unique and intimate perspective of their lives as gardeners, plantsmen, and

farmers. For the Founding Fathers, gardening, agriculture, and botany were elemental passions, as deeply ingrained in their characters as their belief in liberty for the nation they were creating. Author Andrea Wulf reveals for the first time this aspect of the Revolutionary generation. She describes how, even as British ships gathered off Staten Island, George Washington wrote his estate manager about the garden at Mount Vernon; how a tour of English gardens renewed Thomas Jefferson's and John Adams's faith in their fledgling nation; how a trip to the great botanist John Bartram's garden helped the delegates of the Constitutional Congress to break their deadlock; and why James Madison is the forgotten father of American environmentalism. Taken together, these and other stories are a revelation of a guiding but previously overlooked ideology of the American Revolution. "Founding Gardeners" adds depth and nuance to our understanding of the American experiment, and paints a portrait of the Founding Fathers as they've never been seen before.

Andrea Wulf was born in India and moved to Germany as a child. She trained as a design historian at Royal College of Art and is the author of *The Brother Gardeners* (long-listed for the Samuel Johnson Prize 2008 and winner of the American Horticultural Society 2010 Book Award) and the co-author (with Emma Gieben-Gamal) of *This Other Eden: Seven Great Gardens and 500 Years of English History*. She has written for *The Sunday Times*, the *Wall Street Journal*, *The Financial Times*, *The Garden*, and regularly reviews for several newspapers, including the *Times Literary Supplement*, the *Guardian*, and the *New York Times*. She lives in London.

(Adult Programs continued on page 8)





Winter Soup 'n Walks

Nature, Nurture, and Nutrition

SATURDAYS, FEBRUARY 19, MARCH 19, APRIL 23, 11 A.M.–1:30 P.M.
FEE: \$20 MEMBERS, \$25 GENERAL PUBLIC

Pre-registration required; register online at www.adkinsarboretum.org or call 410-634-2847, ext. 0.

Discover winter's welcome greenery and the excitement of early spring blooms. Following a guided walk with a docent naturalist, enjoy a delicious and nutritious lunch along with a brief lesson about the meal's nutritional value. Copies of recipes are provided.

February 19

Find the Greens Plants that Cherish the Warm Winter Sun

Mosses, crane-fly orchid, magnolia and holly leaves, pine and red cedar needles, Christmas fern, green stems of strawberry bush and greenbrier

MENU

Thick and hearty vegetable chili

Green salad with creamy cucumber dressing

Brown rice bread with spinach spread

Date oatmeal spice bars



March 19

Check out the Early Purple and Pink Blooms

Skunk cabbage, paw paw, spring beauty, bloodroot
(one- or two-hour walk option)

MENU

Beet and cabbage soup

Black-eyed pea salad

Cornmeal flaxseed muffins

Cherry pie

April 23

Look Again! The Ephemerals are Fleeting Pink and Yellow Blooms

Pink spring beauty, may apple, and dogwood blossoms, yellow trout lily, golden groundsel, sassafras and spicebush blossoms, and white beech tree blossoms
(one- or two-hour walk option)

MENU

Spring lentil soup

Ginger carrot salad with cranberries

Ancient grain bread with orange marmalade

Fudge cake brownies



Classes are open to children ages 3 to 5. Pre-registration is required. Enrollment is limited to 15 children, so early registration is recommended. The fee for a session of six classes is \$45 for members and \$55 for the general public. Each class includes a snack and a craft. Programs are led by popular children's teacher Jenny Houghton. Register online at www.adkinsarboretum.org, or call 410-634-2847, ext. 0, or e-mail info@adkinsarboretum.org.

Session 1: Tuesdays, 10–11:15 a.m.

Session 2: Fridays, 10–11:15 a.m.

Super Skunks

FEBRUARY 8 AND 11

Roses are red, violets are blue, skunks aren't sweet, but they need love, too. In this lesson, we'll make Valentine skunk puppets, discover fascinating skunk facts, and take a forest walk in search of possible skunk dens.



Welcome, Robins!

FEBRUARY 15 AND 18

Though wintry days are still ahead, the red-breasted robin reminds us that spring will return. We'll go on a pretend journey with this songbird of the thrush family, join voices in "Rock-a-bye Robin," and try our hand at making nests the way robins do.

Terrific Tracks

FEBRUARY 22 AND 25

Which animals are out and about in the cold? Become an expert tracker and find out! We'll identify common animal tracks and make our own tracks through the woods, then return to the classroom to warm up with hot chocolate and winter animal stories.

Lively Leaf Litter

MARCH 1 AND 4

We all know that bears snooze through much of the winter, but what about smaller critters like bugs and worms? Let's go on a leaf litter adventure to find out! We'll make a creepy-crawly craft, explore the forest floor, and finish our lesson with a snack of ever-popular "dirt cups."

Let's Go Fly a Kite

MARCH 8 AND 11

Celebrate blustery March with a lesson on wind, then make a kite and enjoy the wind's uplifting power! We will fly our kites in the meadow and read windy poems during snack time.

Sproutin' Seeds

MARCH 15 AND 18

It's time to start thinking about your summer garden! Learn about the parts of a seed through seed dissection, start your own seeds in a nifty egg carton tray, and plant a sticker garden. Then visit the Arboretum greenhouse and enjoy a picnic snack.

Spring 2011

A six-week spring preschool program will begin on April 12. Parents may choose from Tuesday or Thursday classes. The spring program description will be posted on the Arboretum website by March 1.

(Children's Programs continued on page 10)

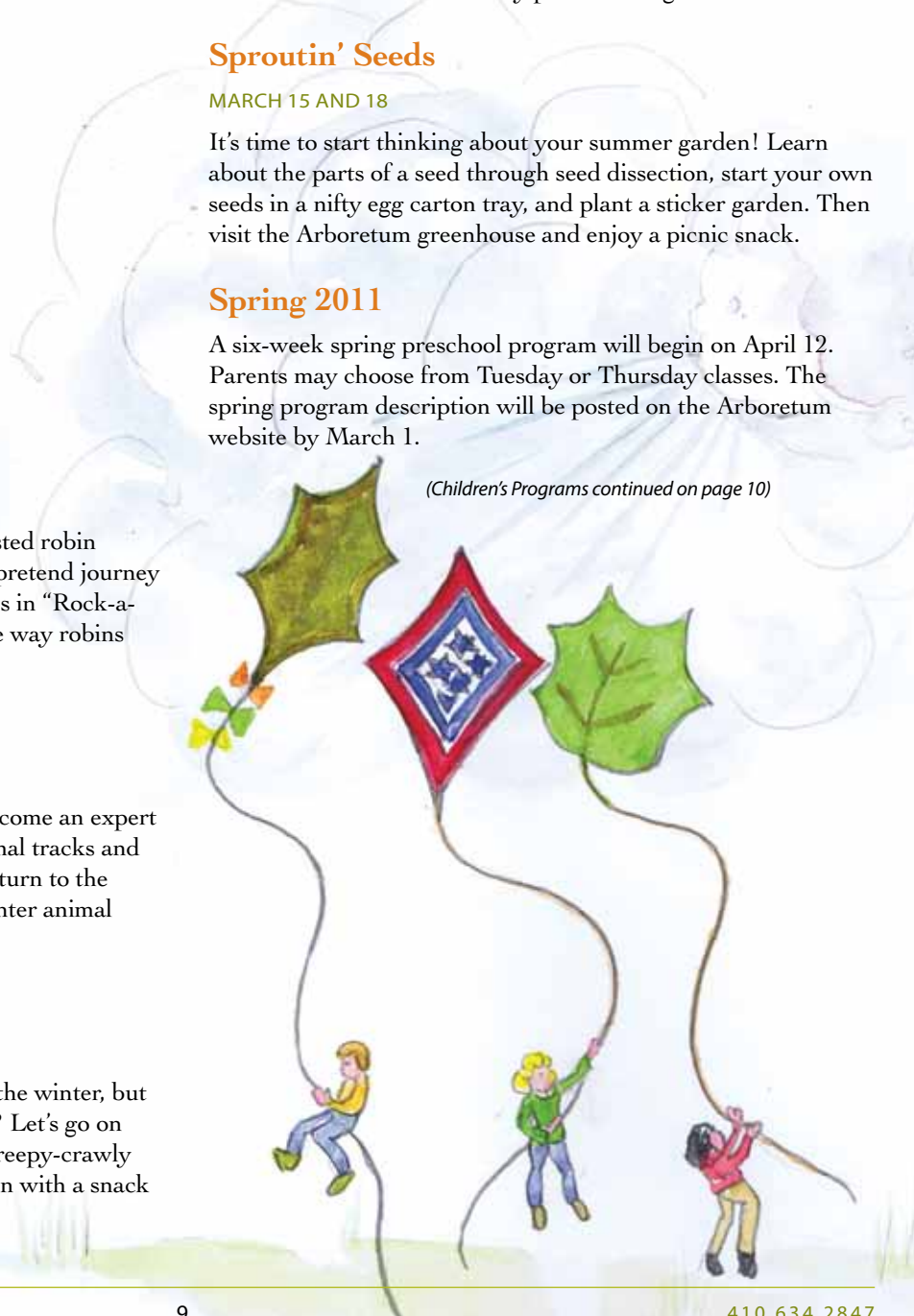



SUMMER BELONGS TO CHILDREN. For the past six years, families and children have grown with the Arboretum’s Kids Camp series. The camps are extraordinary opportunities for children to enjoy summer while exploring and becoming a part of the Arboretum.

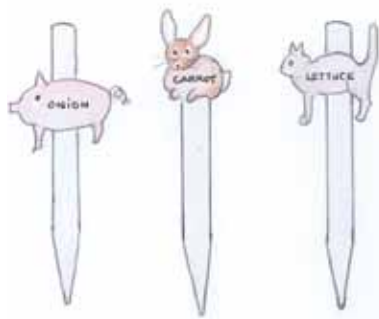

This year, campers will experience the Arboretum in a variety of ways. Preschoolers can join Camp Pollywog’s “Growing Up Green” to learn about the life cycles of plants and animals, or Camp Bumblebee’s “Sunny Days” to learn why the children’s Funshine Garden is such a special place.

NEW this year, Camp Dragonfly’s “Dragons in the Marsh!” will awaken the curiosity of 6- to 8-year-olds as they experience the magic of the wetland. Camp Paw Paw, also for 6- to 8-year-olds, will explore the magic of the forest in “Into the Woods.” In Camp Egret’s “Wetland Survivor,” 9- to 12-year-olds will embark on a week of action-packed wetland adventures.

Arboretum membership has its benefits! Members receive a discount on camp fees and may pre-register for summer camp. Member registration opens March 1. The general public may register beginning March 15.

2011 CAMP DATES:

Camp Bumblebee (ages 3–5): June 13–17

Camp PawPaw (ages 6–8): June 20–24

Camp Pollywog (ages 3–5): June 27–July 1

Camp Dragonfly (ages 6–8): July 11–15

Camp Egret (ages 9–12): July 18–22

High-schoolers: You’re never too old to come to camp! Did you love summer nature camp when you were younger and now have community service hours to fill for graduation? Spend a week at Adkins Arboretum, helping younger campers catch frogs and hike the paths and sharing your enthusiasm for the outdoors. You must be at least 14 years old, enjoy spending time with children outside, and participate in an interview and training session. If you are interested, call Jenny Houghton at 410-634-2847, ext. 26 or e-mail at jhoughton@adkinsarboretum.org.

Family Backpacks Take the Classroom Outside

The Funshine Garden. Preschool programs. Camps Paw Paw, Pollywog, Bumblebee, and Egret. Puppet shows at the Festival of Leaves, fairy houses in the woods. For all this and more, the Arboretum has long been an excellent destination for families. Through the generosity of the Fullwood Foundation, the Arboretum now has even more to offer families looking to learn from the great outdoors: four self-guided education backpacks, centered on **stream, wetland, forest,** and **wildlife** themes.

Each of the four backpacks contains materials and supplies for a family or small homeschool group and includes field guides, hand lenses, clipboards, sketchbooks, and binoculars. Nets and collection containers are included in the Stream and Wetland backpacks. All packs contain lessons and activities designed for school-aged children, touching upon concepts of stewardship, biodiversity, and watershed/land conservation issues. Family backpacks are available for reservation at the front desk, and use of the packs is included in the price of admission.

Albert Einstein once suggested,
“Look deep into nature, and then you will understand everything better.”

Family Backpacks at the Arboretum are a first step on that journey toward understanding.



FEBRUARY

Sunday	Monday	Tuesday	Wednesday	Thursday	Friday	Saturday
JANUARY 19 Exploring Nature and Five Movements of Life Through Writing, Reflection, and Community, 1–4 p.m.		1	2	3	4	5 Nature as Muse – Walk and Reflection with Nature Journaling 11 a.m.
6 Sumi-e Painting 1–3 p.m.	7	8 Children’s Program 10–11:15 p.m.	9	10	11 Children’s Program 10–11:15 p.m.	12
13	14	15 Children’s Program 10–11:15 p.m.	16	17	18 Children’s Program 10–11:15 p.m.	19 Soup’n Walk 11 a.m.–1:30 p.m.
20	21 Nature-Inspired Texture Painting 12:30–3:30 p.m.	22 Botanical Art: A Continuing Tradition 1–2 p.m. Children’s Program 10–11:15 p.m.	23	24	25 Children’s Program 10–11:15 p.m. A Garden Odyssey—In Search of the World’s Most Creative Gardens, 1–2 p.m.	26
27	28 Nature-Inspired Texture Painting 12:30–3:30 p.m.					

MARCH

Sunday	Monday	Tuesday	Wednesday	Thursday	Friday	Saturday
		1 Children’s Program 10–11:15 p.m.	2	3	4 Children’s Program 10–11:15 p.m. Energy-Wise Landscape Design 1–2:30 p.m.	5 Nature as Muse 11 a.m.
6 Sumi-e Painting 1–3 p.m.	7	8 Children’s Program 10–11:15 p.m.	9	10	11 Children’s Program 10–11:15 p.m.	12
13 Surrealistic Landscapes 12:30–3:30 p.m.	14	15 Volunteer Orientation 10 a.m.–noon Children’s Program 10–11:15 p.m.	16 Landscape Audits 1–2:30 p.m.	17	18 Children’s Program 10–11:15 p.m.	19 Soup’n Walk 11 a.m.–1:30 p.m.
20 Nature’s Role in the Underground Railroad 1–3 p.m.	21	22	23	24	25	26 Landscape Design Workshop 8:30 a.m.–4:30 p.m.
27 Surrealistic Landscapes 12:30–3:30 p.m.	28	29	30	31		

APRIL

Sunday	Monday	Tuesday	Wednesday	Thursday	Friday	Saturday
					1 Chanticleer Garden 8 a.m.–5 p.m.	2 Nature as Muse 11 a.m.
3 Illuminated Garden Journals 1–3:30 p.m.	4	5	6 Exploring Nature and Five Movements of Life 1–4 p.m.	7 Gap Ecology 10–11:30 a.m.	8	9 Arbor Day Run 8 a.m. Nature's Role in the Underground Railroad 1–3 p.m.
10 Illuminated Garden Journals 1–3:30 p.m.	11	12	13	14	15	16 Designing Extraordinary Mixed Plantings 1–2 p.m.
17	18	19	20 Bowman Hill Trip 8 a.m.–6 p.m.	21	22 Designing the Native Forest 10 a.m.–2:30 p.m.	23 Soup 'n Walk 11 a.m.–1:30 p.m.
24	25 Founding Gardeners Noon lunch 1 p.m. lecture	26	27	28 Ecology of the Forest in Spring 1–3 p.m.	29 Designing the Native Forest 10 a.m.–2:30 p.m.	30 Nature's Role in the Underground Railroad 7–9 p.m.

Art At The Arboretum

The Arboretum sponsors art exhibitions throughout the year, including an annual competition and outdoor environmental art. Call 410-634-2847, ext. 0 or e-mail info@adkinsarboretum.org for gallery hours.

Rachel Rotenberg's cedar sculptures will be on view through January 28. Using cedar wood as her primary material, Rotenberg sometimes adds a little color with oil paint and incorporates twisted vines, wire, or other found objects. The relationships of forms, textures, and colors in these abstract sculptures hint at stories of deeply felt memories and intuitions.



Rachel Rotenberg, *Encampment*, cedar, vine, oil paint

The Arboretum's annual juried art show, 2011 Art Competition, *Discovering the Native Landscapes of Maryland's Eastern Shore*, will be on view February 14 through March 25. Now in its twelfth year, this show draws entries in many different media by artists from the mid-Atlantic area and beyond. The juror for this year's show is Ricky Sears, Visiting Faculty in the Department of Art, Washington College, Chestertown. There will be a reception Saturday, February 26 from 3 to 5 p.m.

Arbor Day 5K Run & Family Fun Run/Walk

SATURDAY, APRIL 9
REGISTRATION 8–8:45 A.M.
START TIME 9 A.M.
5K FEE (INCLUDES WATER BOTTLE): \$20;
\$25 DAY OF EVENT
FAMILY FUN RUN/WALK FEE:
\$15/FAMILY

Join fellow runners and nature enthusiasts for the sixth annual Arbor Day Run. The event, which also features a 5K Run and a one-mile Family Fun Run/Walk, will kick off with a Kids' 100 Yard Dash at 8:45 a.m. Participants will catch glimpses of spring as they traverse the cross-country course plotted along the Arboretum's network of scenic forest and meadow paths. Prizes will be awarded and refreshments provided. Register online, call 410-634-2847, ext. 0, or e-mail info@adkinsarboretum.org.

